

1 END VIEW

Scale: 3/4" = 1'

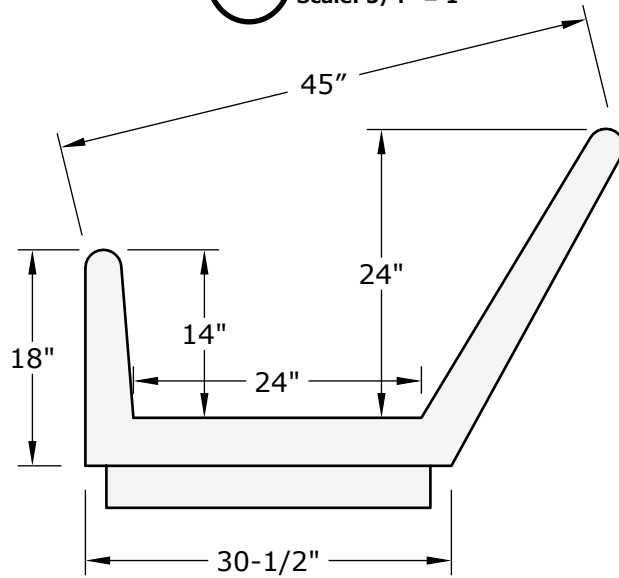

2 SIDE VIEW

Scale: 3/4" = 1'

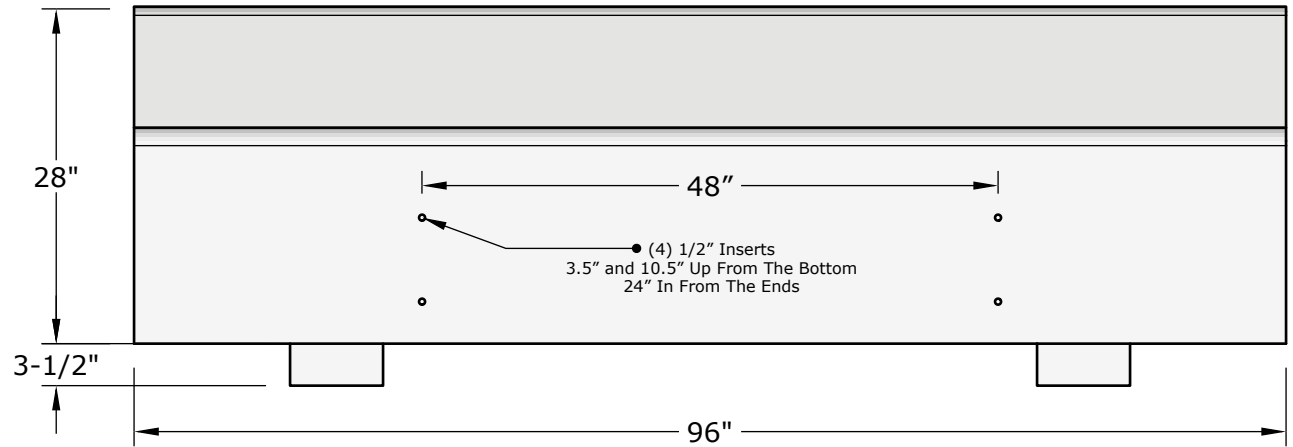

3 ISO VIEW

NOT TO SCALE

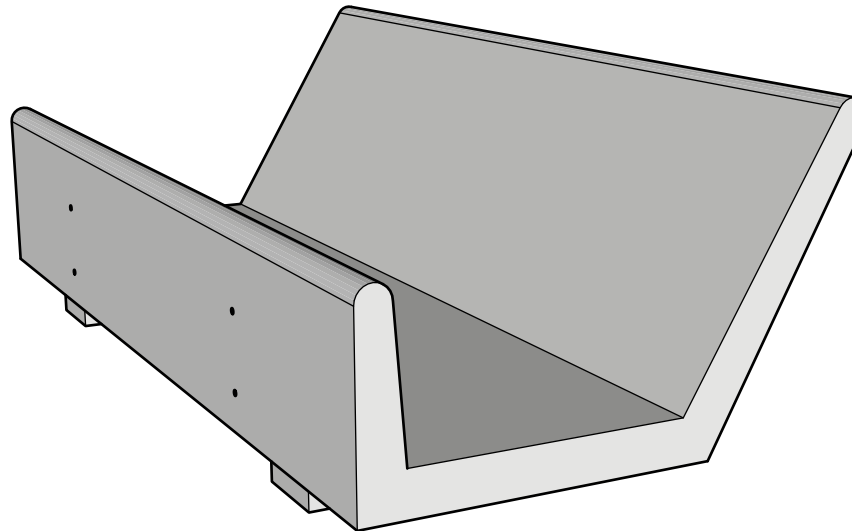

NOTES

Reinforced throughout with 6x6 10x10 Steel Mesh as well as (5) pieces of #4 Rebar bent into a J shape and a piece of #4 rebar running horizontally along both of the two upper edges.

2,400 Lbs Total Weight

TITLE

J-Bunk Cattle Feeder

DATE 03/02/22

REVISION 1.2

THE FAGENSTROM CO.

2101 NORTHWEST BYPASS
P.O. Box 2623
GREAT FALLS, MT 59403
WWW.FAGENSTROM.CO
406-761-5200

